

Micro LED CTC

LED Surface Mounts for Bright, General Illumination From A Small, Sleek Style. Indoor or Outdoor with 75% Energy Savings and Lasts 40 Times Longer.

Finally, a fresh, modern approach to the old fashioned close-to-ceiling surface mount lights ideal for circulation spaces, living spaces and wet locations. This Contemporary Micro LED Close-To-Ceiling fixture with a matte white body and a translucent white acrylic diffuser mounts simply to a standard 4 inch J-box and is less than 2" deep in a crisp, flat edged style that provides a sophisticated look. Rethinking Lighting in the LED Revolution allows a large amount of light for general illumination from small unobtrusive sizes that will beautifully blend in to every application, indoor or outdoors. A warm, modern white 3000K color temperature is under 15 watts and illuminates like the output of 50W Par 20 and 75W BR30. Retrofit to an existing recessed 6" white can with a simple recessed accessory.



These Micro LED Close-to-Ceiling fixtures are a particularly good solution in wet location applications where normally a much larger and usually simple utilitarian look is used like in outdoor breezeways and shower/bathroom applications. They are also stylish substitutes for recessed downlights especially where ceiling obstructions or codes make a surface mount a good solution. It is ideal for applications that require expensive fire rated boxes for recessed fixtures since these mount simply to a surface mounted junction box.



Ideal Applications

Outdoor Breezeways

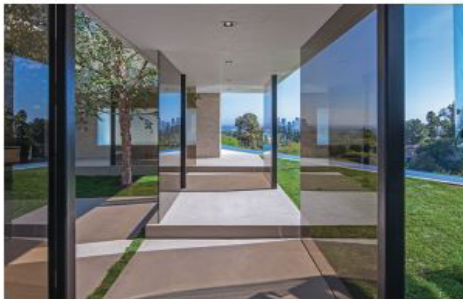

Since the SMC Series are wet location rated and less than 15 watt, they are ideal for long, outdoor breezeways.

Replace Expensive Downlights



Fire Rated Recessed Housing
Avoid expensive Fire Rated Recessed housing by using the SMR series in a standard 4" Junction-box with bright, comfortable lighting at budget pricing.

Showers / Wet Locations



Add less than 15 watts to your shower or tub but lots of light that will make a big difference in how good you look.

Recessed Accessory Kit

Order separately to easily adapt the LMC series to 6" white cans. Save over 75% energy from incandescent equivalent fixtures and lasts 40 times longer.



6" Accessory Kit



Specifications

Heavy gauge metal housing powder coated white houses 120V LED array and is dimmable with standard incandescent dimmers.* LED are comfortably diffused with Translucent White Opal Acrylic diffuser to provide a glare free light.

Mounting

Surface mounts to standard 4 inch junction box with two screws. Mounts to most 6" white cans with a recessed accessory kit.

LED Engine

LMC 6 inch 44 LED arrays providing 1000 lumens with the diffuser and 15 watts with 3000K color.

Dimming

LMC Series dims to 10% with standard dimmers.*

* Triac Based (forward phase control or leading edge dimmers).

Note: Specifications subject to change without notice.

Listing

ETL Wet Location

Warranty

5 Year Limited Warranty

ITEM NO.	DESCRIPTION	DIMENSIONS
LMC6L15W1000L12030KBN	Surface Mount LED 15W 1000 Lumen Brushed Nickel, 44 LEDs CRI>80, 3000K, Dimmable. 35000 Hours.	7.4" OD x 1.26"H
LMC6L15W1000L12030KWH	Surface Mount LED 15W 1000 Lumen White, 44 LEDs, CRI>80, 3000K, Dimmable. 35000 Hours.	7.4" OD x 1.26"H
LMC6RECACC	Recessed accessory Kit to retrofit LMC6L Series into 6" recessed white can housings.	