

# 44 PLUS JOINER BOX

## Joining Component

### APPLICATIONS

The 44 Plus Joiner Box provides a sleek and modern solution for joining multiple linear fixtures to produce a visually appealing continuous run. Easily create custom runs featuring 90° turns, as well as "X" and "T" patterns. The joiner box is available in the same colors as the linear fixtures for the perfect match and finish.

### FEATURES & BENEFITS

- Joiner Box can be pendant hung by stem or cable
- Available in 1 Way, 2 Way, 3 Way and 4 Way options
- Seamless design that is both fashionable and functional

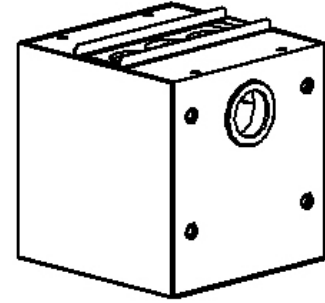

### SPECIFICATIONS

Formed and welded 22-gauge cold rolled steel.  
 Internal press in nuts creates ease of joining assembly.  
 Grommeted wire ways protect wiring.

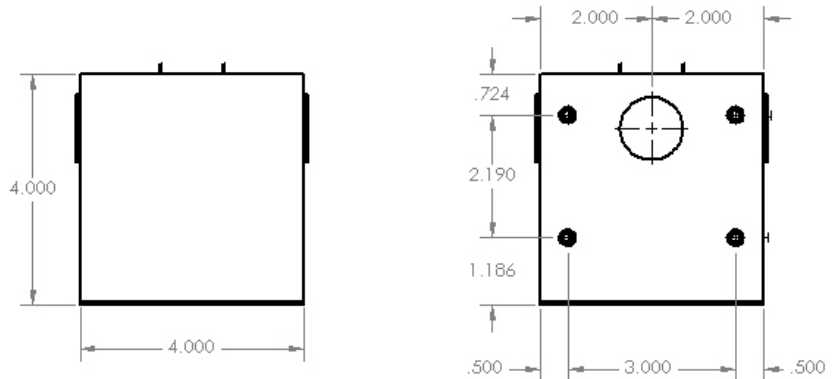

### ORDERING DATA

EXAMPLE: 44\_J2WAY\_P\_WH

Series	Configuration	HK	Finish
44_JB	<b>J1WAY (STRAIGHT JOINER)</b> <b>J2WAY (90° JOINER)</b> <b>J3WAY (T CONNECTOR 3-WAY)</b> <b>JB2180WAY (X CONNECTOR)</b> <b>E10WAY (END OF RUN)</b>	<b>P</b> Power <b>NP</b> Non-Power	<b>WH</b> White <b>BK</b> Black <b>SL</b> Silver <b>IN</b> Iron <b>BZ</b> Bronze

### Options

Part Number	Description
P11	3 wire harness, including white, black and green
P12	4 wire harness, including white, black, green and blue for emergency battery backup
P13D	5 wire harness, including white, black, green, violet and gray

<b>A-HC301WH</b>	Cable kit with 4 cable + power feed cable incl. with white canopy
<b>A-HC301WH5W</b>	Cable kit with 4' cable + power feed 0-10V dimming cable included with white canopy (5 wire)
<b>A-HC302WH</b>	Cable kit with 12' cable + power feed cable incl. with white canopy
<b>A-HC302WH5W</b>	Cable kit with 12' cable + power feed 0-10V dimming. Cable included with white canopy (5 wire)

